



SMA TORQUE WRENCH
Part No. SZP19B281637

Features & Benefits:

1. A standard type for bolt tightening application
2. A click will signal that the proper amount of torque has been applied
3. Easy operation and user comfort
4. Safety and reduce possibility of damage
5. Compact, durable and reliable
6. Durable gear and Strong reaction arm

PRODUCT PACAKING



Parameter Type	Specification	Tolerance	Unit
Appearance Size	115*φ15		mm
Orifice Diameter	φ8.0	±0.1	mm
Torque Value	1	±0.1	N*M
Weight	0.2		Kg
Appearance Color	Pink		

APPEARANCE STRUCTURE

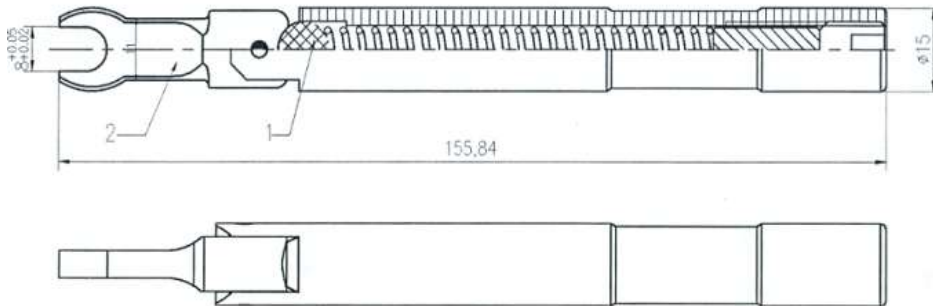

TORQUE VALUE

